



MODEL 82306 200 LBS. CAPACITY SINGLE TIRE/WHEEL LIFT SETUP OPERATING MAINTENANCE INSTRUCTIONS

Note: Revision letters (A, B, C, D etc.) after model numbers have been omitted as they do not affect the setup, operating and maintenance instructions of a particular jack unless otherwise noted.

IMPORTANT: READ THESE INSTRUCTIONS BEFORE OPERATING

BEFORE USING THIS DEVICE, READ THIS MANUAL COMPLETELY AND THOROUGHLY, UNDERSTAND THEIR OPERATING PROCEDURES, SAFETY WARNINGS AND MAINTENANCE REQUIREMENTS. FAILURE TO DO SO COULD CAUSE ACCIDENTS RESULTING IN SERIOUS OR FATAL PERSONAL INJURY AND/OR PROPERTY DAMAGE.

The use of this device is subject to certain hazards that cannot be prevented by mechanical means, but only by the exercise of intelligence, care, and common sense. It is therefore essential to have owners and personnel involved in the use and operation of equipment who are careful, competent, trained, and qualified in the safe operation of the equipment and its proper use. Examples of hazards are dropping, tipping, or slipping of loads caused primarily by improperly securing loads, overloading, off-centered loads, use on other than a hard level surface, and using equipment for a purpose for which it was not designed.

It is the responsibility of the owner to make sure all personnel read these manuals prior to using this device. It is also the responsibility of the device owner to keep these manuals intact and in a convenient location for all to see and read. If the manuals are lost or not legible, contact Norco Industries, Inc. for free replacements. If the operator is not fluent in English, the product and safety instructions shall be read to and discussed with the operator in the operator's native language by the purchaser/owner or his designee, making sure that the operator comprehends its contents.

WARRANTY

This product is covered by a Limited Lifetime Warranty. For details see the back cover of Norco's product catalog.

WARNING

- Inspect the device before each use. Do not use the device if it is damaged, altered, modified, in poor condition, leaking air, or has loose or missing hardware or components. Take corrective action before using the device.
 - Do not exceed rated capacity. Use only on a hard level surface.
 - Stay out from underneath a load that is being lifted or suspended.
 - Apply load as close to the vertical portion of the lifting member as possible.
 - Before moving the load, assure that the load is centered and secured with the load restraint device provided.
 - Before moving, lower the load to the lowest possible point.
 - No alterations or modifications shall be made to this product.
-

SETUP

ASSEMBLY

1. Remove the components and the installation accessories from the package.
2. Check that the lift is in perfect condition, ensuring that no parts are damaged or missing.
3. Assemble the lift according to the attached exploded drawings.
4. Make sure all screws are tightened properly.

PNEUMATIC LINE CONNECTION

The air supply must be connected to the supplied lubricator.

1. Mount the lubricator to the back of the post.
 2. Connect the pneumatic lines preassembled to the lubricator.
 3. Connect the servicing unit to the pneumatic supply at site.
 4. Check the pneumatic control operations for proper performance.
-

OPERATING INSTRUCTIONS

1. Unlock the rear locking caster wheels by pulling up the locking plate on each caster wheel.
2. Position the lift close to the wheel to be lifted
3. Attach the air supply to the connector on the left side of the oil lubricator.
4. Push forward the air valve switch lever (fig. 1) to lower the lift to its minimum height.
5. Loosen the two black knobs securing the two lifting arms in place, then adjust the width and length of the lift arms according to the size of the tire/wheel to be lifted.
6. Place the tire/wheel on and between the the lift arms and secure it with the tie down strap provided. Then move the lift to the desired location.
7. Raise the lift by pulling back on the air valve switch lever. Lower the lift as needed by pushing forward on the air valve switch (fig. 2).
8. Stop the lift at the desired height by releasing the switch lever
9. Carefully transfer the tire/wheel onto a tire changer, wheel balancer, or a vehicle.
10. Lower the lift and move it to a safe location.

PREVENTATIVE MAINTENANCE

1. Always store the tire/wheel lift in a well protected area where it will not be exposed to inclement weather, corrosive vapors, abrasive dust, or any other harmful elements. The lift must be cleaned of water, snow, sand, or grit before using.
2. Lubricate moving parts once a month with a general purpose grease. Keep the air piston rod clean and undamaged at all times to minimize wear and damage to seals.
3. Maintain oil in the lubricator at all times. Check oil level as needed depending on the amount of lift usage.
4. Check/listen for air leakage in air valve, air lines & connections. Repair as needed.
5. Every tire/wheel lift owner is responsible for keeping the lift label clean and readable. Use a mild soap solution to wash external

surfaces of the lift but not any moving hydraulic components. Contact Norco Industries for a replacement label if your lift label is unreadable.

6. Inspect the tire/wheel lift before each use. Do not use the lift if any component is cracked, broken, bent, shows signs of damage, or is leaking air. Do not use the lift if it has loose or missing hardware or components, or is modified in any way. Take corrective action before using the lift again.

7. Do not attempt to make any repairs unless you are a qualified repair person that is familiar with this equipment. Contact Norco's customer service department for repair parts.

TROUBLESHOOTING GUIDE

SYMPTOM:	POSSIBLE CAUSE:	SOLUTION:
The lift arms do not raise up, or the lift will not raise the rated capacity.	The air supply is not connected.	Connect the air supply.
	The air pressure is not sufficient.	Increase the air pressure.
	Air pressure is being lost due to an air leak(s).	Check hose, air valve, and air cylinder connections. Tighten or repair as needed.
	The seal in the cylinder is worn out.	Check and replace if necessary.
	The air valve is defective.	Check and replace if necessary.
	There is a pinched air hose cutting off or restricting the air supply.	Fix air hose so air can flow freely.
The lift arms do not lower.	The air valve is defective.	Check and replace if necessary.
The lift arms do not remain in their lifted position.	Air pressure is being lost due to an air leak(s).	Check hose, air valve, and air cylinder connections. Tighten or repair as needed.
	The seal in the cylinder is defective.	Check and replace if necessary.
The lift arms do not raise up smoothly.	One or more of the plastic sliders is damaged.	Check and replace if necessary.
	The air cylinder and/or chain assembly is being obstructed by a foreign object.	Find and remove the obstruction.

REPAIR SERVICE

If your Norco product requires service or repair, contact the Norco Customer Service Department for the location of the nearest Norco Authorized Service Center.

Norco Industries, Inc.
 365 West Victoria St.
 Compton, CA 90220
 (310) 639-4000 • Fax: (310) 639-7411
www.norcoindustries.com

It will be necessary to provide the Norco Authorized Service Center with a copy of the bill of sale if requesting warranty repair. If the authorized service center determines your product is eligible for warranty repair, the repair will be made at no charge and returned freight prepaid. The cost of non-warrantable service, repair, and return freight is the customer's responsibility.

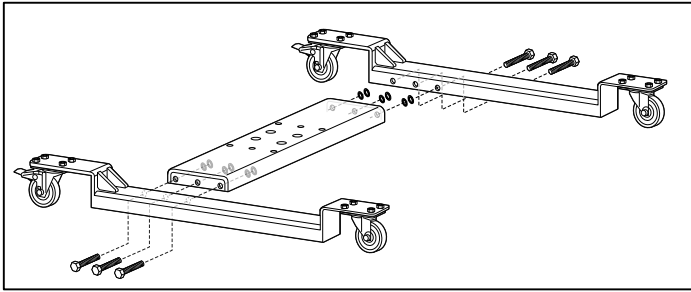

1.

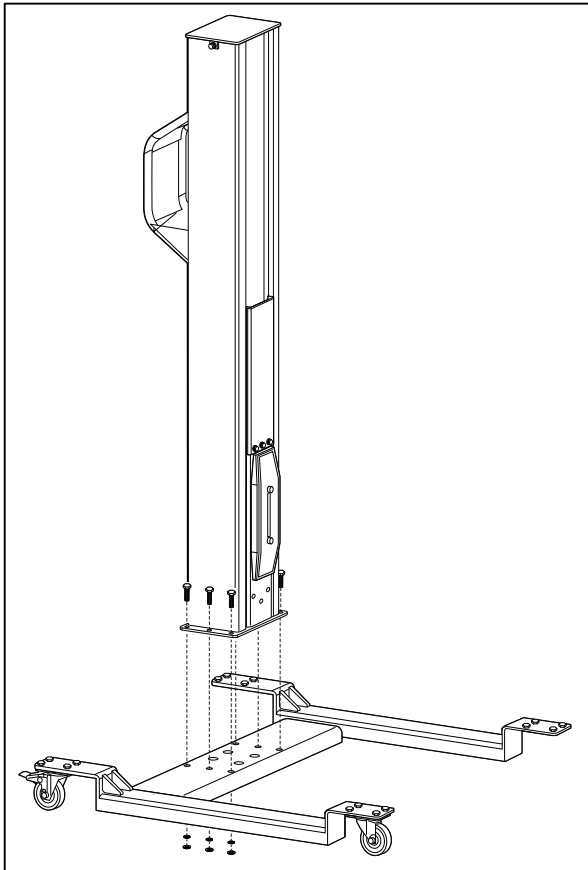

2.

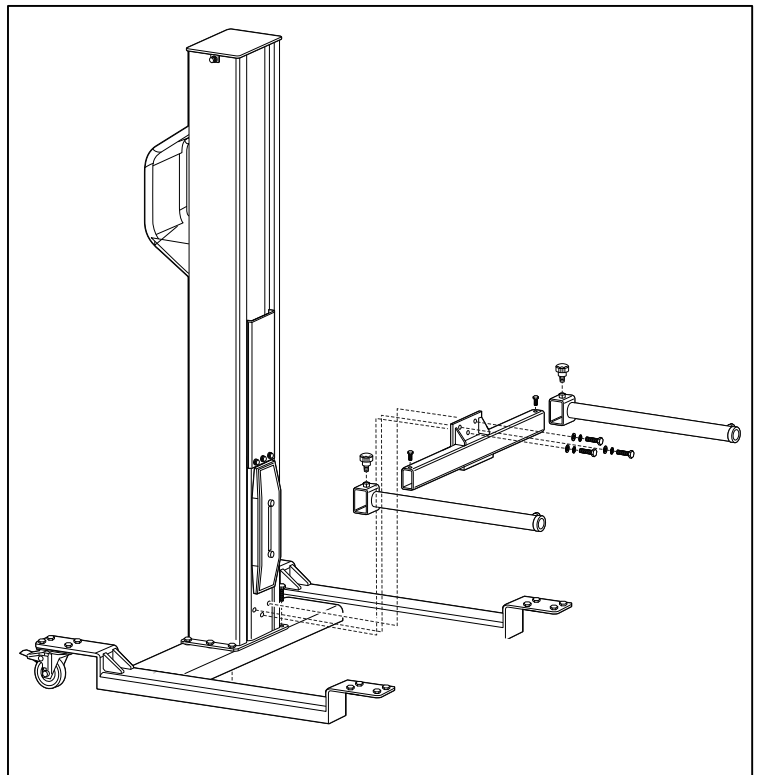

3.

